

# LEISURE PARK

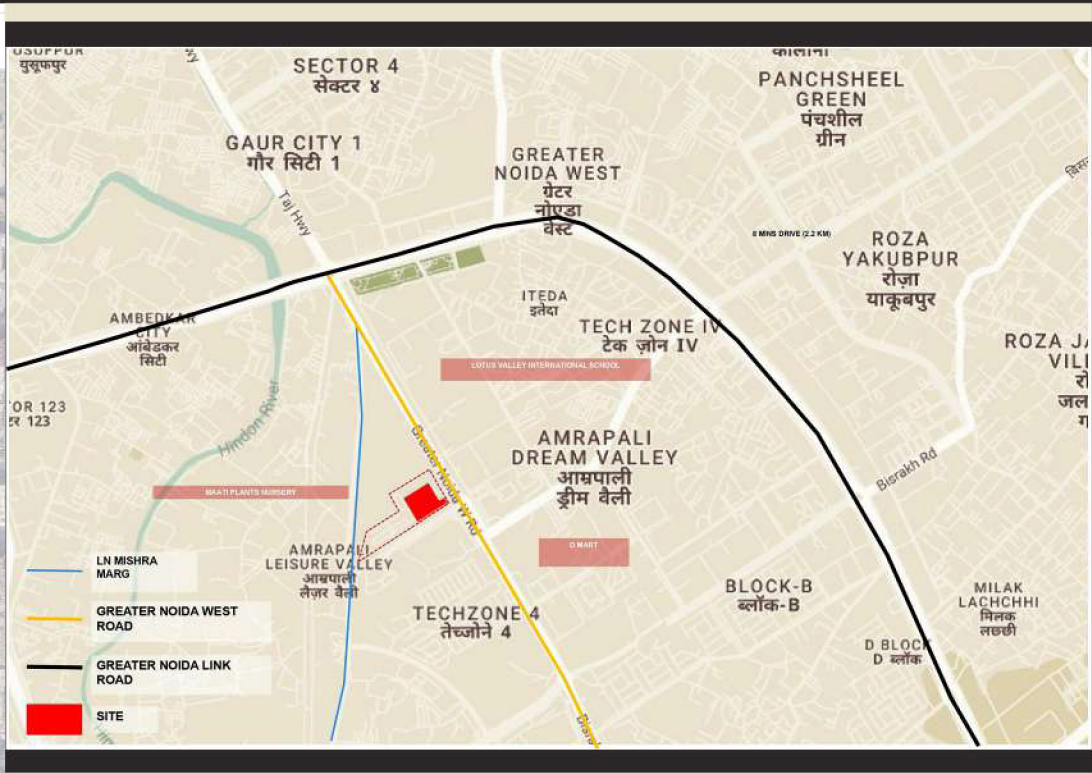

MASTER PLAN











### PROJECT HIGHLIGHTS



GREAT  
CONNECTIVITY



HABITABLE  
COMPLEX



GREEN BUILDING  
CERTIFICATION



LUXURY CLUB HOUSE  
WITH SWIMMING POOL



INDOOR GAMES  
FACILITY



TWO YEAR  
MAINTENANCE FREE  
WITH ELEMENT



24X7 SECURITY



AERIAL VIEW













## THE ICONIC TOWER

**2 UNITS OF 4BHK APARTMENTS  
ON A FLOOR**

Large, spacious apartments with  
Premium finishes



LEISURE PARK



[WWW.NBCCINDIA.GOV.IN](http://WWW.NBCCINDIA.GOV.IN)



OUTDOOR FACILTY



OPEN GYM

- Sports
- Two Badminton Courts
  - HalfBasketball Court
  - Yoga Lawn for morning and evening activities



HUMAN LUDO



GAZEBO SEATING



KID'S PLAY ARAE



LEISURE PARK

OUTDOOR FACILTY



- Indoor Games Area
- Ideal for solo and group activities
  - Features include Pool Table, Board games, Air Hockey, and Football



- Club & Swimming Pool
- Spacious, open-plan layout for socializing
  - Large swimming pool surrounded by greenery
  - Versatile areas for hosting events and small gatherings

- Community Hall
- Capacity of 70-80 people
  - Includes a stage, seating area, serving area, and washrooms
  - Ideal for large gatherings



- Cafeteria and Coffee Shop
- Indoor outdoor seating for 52 people
  - Bar tables and sofa seating available

INDOOR FACILITY

- Gymnasium
- Modern workout machines and changing rooms
  - Dedicated spaces for cardio and weight training



Images for reference only



# OUTDOOR FACILTY



OPEN GYM

**Open Gym**

- Refreshing alternative to traditional indoor fitness.

**Human Ludo**

- Unique twist to outdoor fun with EPDM flooring.
- Giant version of classic board game.

Playful and interactive for families and friends.



HUMAN LUDO



GAZEBO SEATING

**Gazebo Seating**

- Tranquil retreat for relaxation.
- Ideal for rendering and enjoying nature.
- Suitable for quiet moments or casual gatherings with friends and family or hosting events and small gatherings



TWO BADMINTON COURTS

**Sports**

- Two Badminton courts
- Half Basketball court
- Yoga lawn for morning and evening activities.



KID'S PLAY AREA

**Kid's Play Area**

- Dedicated space for safety and fun.
- Features swings, slides and a sand pit.
- Encourages children to play and explore securely.



HALF BASKETBALL COURT

*Images for reference only*



# INDOOR FACILITY



- Club & Swimming Pool**
- Spacious, open-plan layout for **socializing**
  - Large **swimming pool** surrounded by greenery
  - **Versatile areas** for hosting events and small gatherings



- Gymnasium**
- Modern workout machines and changing rooms
  - Dedicated spaces for cardio and weight training

- Indoor Games Area**
- Ideal for **solo** and **group activities**
  - Features include **Pool Table, Board games, Air Hockey, and Football**

- Community Hall**
- Capacity of **70-80 people**
  - Includes a **stage, seating area, serving area, and washrooms**
  - Ideal for **large gatherings**

- Cafeteria and Coffee Shop**
- **Indoor outdoor** seating for **52 people**
  - **Bar tables** and **sofa seating** available



Images for reference only



# ICONIC CLUSTER



TYPICAL FLOOR PLAN  
(2 UNIT PLAN)

COMMON TERRACE  
(3rd,8th,13th,18th,23rd,28th&33rd)



4BHK+SER.ROOM - UNIT PLAN (ICONIC TOWER TYPICAL PLAN)

SUPER BUILT UP AREA (SQ.MT)/(SQ.FT.) 350 SQM/3769 SQ.FT.

Area name	Feet & Inches (Length x Width)
Drawing room	17'8" X 16'0"
Dining room	11'1" X 12'5"
Balcony 1	4'3" wide (varies)
Balcony 2	6'10" wide (varies)
Store	4'11" X 11'5"
Powder Toilet	5'2" X 6'6"
Master Bedroom	12'9" X 15'5"
Dress	5'10" X 6'10"
Toilet-1	5'10" X 7'6"
Balcony-3	6'10" wide (varies)
Bedroom- 1	11'5" X 11'9"
Wardrobe	6'10" X 1'11"
Toilet-2	8'2" X 5'10"
Bedroom- 2	10'5" X 10'9"
Wardrobe(Bedroom:2)	1'11" X 6'6"
Toilet-3	7'10" X 5'2"
Balcony-4	4'11" wide (varies)
Bedroom- 3	12'9" X 11'5"
Toilet-4	7'10" X 5'10"
Kitchen	9'10" X 9'10"
Pooja niche	3'11" X 6'6"
Servant room	8'10" X 8'10"
Toilet-5	4'11" X 5'10"
Powder Toilet	5'2" X 6'6"





5BHK+SER.ROOM - DUPLEX UNIT PLAN (ICONIC TOWER)-LOWER/UPPER

SUPER BUILT-UP AREA (SQ.MT.)/(SQ.FT.) 674 SQM / 7262 SQ.FT.





5BHK+SER.ROOM - DUPLEX UNIT PLAN (ICONIC TOWER)-LOWER/UPPER

SUPER BUILT-UP AREA (SQ.MT.)/(SQ.FT.) 674 SQM / 7262 SQ.FT.



Area name	Feet & Inches (Length x Width)
Drawing room	17'8" X 23'7"
Dining room	11'1" X 12'5"
Balcony 1	4'3" wide (varies)
Balcony 2	6'10" wide (varies)
Store	4'11" X 11'5"
Toilet 4	7'10" X 5'2"
Master Bedroom	12'9" X 15'5"
Dress	5'10" X 6'10"
Toilet 1	5'10" X 7'6"
Balcony 3	6'10" wide (varies)
Bedroom- 1	11'5" X 11'9"
Wardrobe(Bedroom:1)	11'5" X 11'9"

Area name	Feet & Inches (Length x Width)
Toilet 2	8'2" X 5'10"
Bedroom- 2	12'9" X 11'5"
Toilet 3	7'10" X 5'10"
Kitchen	9'10" X 9'10"
Servant room	8'10" X 8'10"
Toilet 5	4'11" X 5'10"

LOWER DUPLEX

Area name	Feet & Inches (Length x Width)
Drawing room	16'4" X 20'4"
Terrace	47'6" X 15'5"
Balcony 2	6'10" wide (varies)
Toilet 2	7'10" X 6'6"
Bedroom- 1	11'5" X 11'9"
Wardrobe	6'10" X 1'11"
Toilet 1	8'2" X 5'10"
Balcony 1	4'3" wide (varies)
Bedroom- 2	11'5" X 14'1"
Pantry	14'5" X 5'10"



UPPER DUPLEX



CLUSTER TYPE-1



4 BHK (2 UNIT)

3 BHK (2 UNIT)

CLUSTER TYPE-2

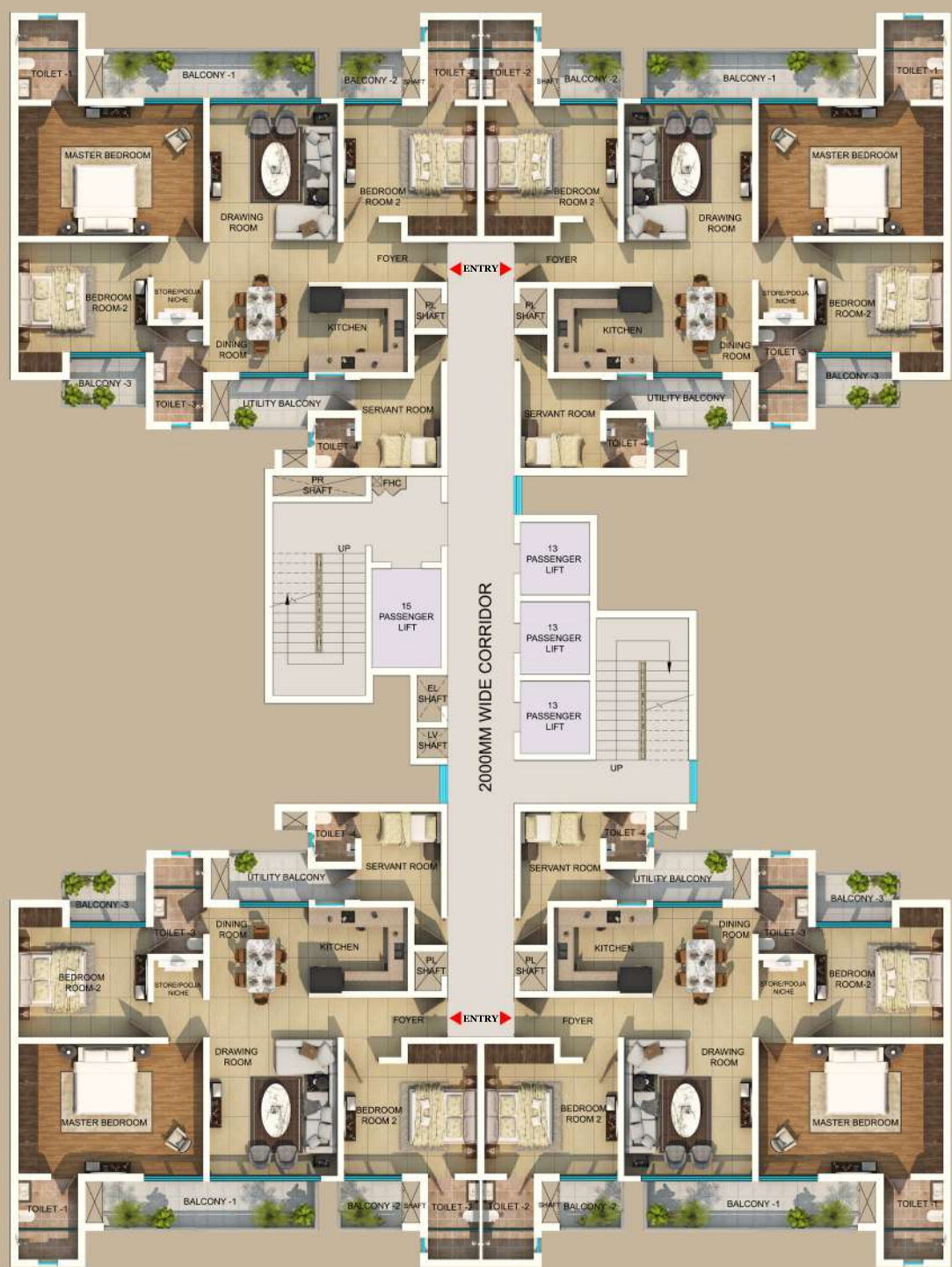

3 BHK (4 UNIT)



4BHK+SER.ROOM- (TYPICAL LAYOUT PLAN)

SUPER BUILT-UP AREA (SQ.MT.)/(SQ.FT.) 258 SQM / 2783 SQ.FT.

Area name	Feet & Inches (Length x Width)
Drawing room	18'-4" X 17'4"
Dining room	9'10" X 8'10"
Balcony-1	16'0" X 4'11"
Utility Balcony	13'1" X 4'3"
Foyer	10'2" X 3'11"
Master Bedroom	16'8" X 11'9"
Dressing room	7'2" X 5'10"
Toilet 1	8'6" X 5'10"
Balcony-2	4'11" X 26'10"
Bedroom- 1	13'1" X 10'9"
Wardrobe	6'10" X 1'11"
Toilet 2	4'11" X 7'10"
Bedroom- 2	11'1" X 10'5"
Wardrobe	5'10" X 1'11"
Toilet 3	5'2" X 7'10"
Balcony 3	5'10" X 3'11"
Bedroom- 3	10'9" X 12'9"
Toilet 4	5'2" X 7'10"
Kitchen	9'10" X 8'2"
Store/Pooja niche	6'10" X 3'11"
Servant room	7'11" X 8'10"
Toilet 5	3'11" X 4'11"
Powder Toilet	5'2" X 4'4"





3BHK+SER.ROOM- UNIT PLAN (TYPICAL LAYOUT PLAN)

SUPER BUILT-UP AREA (SQ.MT.)/(SQ.FT.) 213 SQM / 2299 SQ.FT.

Area name	Feet & Inches (Length x Width)
Drawing room	12'5" X 13'5"
Dining room	9'10" X 8'10"
Balcony 1	20'8" X 4'11"
Utility Balcony	12'5" X 4'7"
Foyer	3'11" X 6'6"
Master Bedroom	16'4" X 12'9"
Wardrobe(Master B)	1'11" X 12'9"
Toilet 1	5'-10" X 7'10"
Bedroom- 1	13'1" X 10'9"
Wardrobe(Bedroom:1)	6'-10" X 1'11"
Toilet 2	4'-11" X 7'10"
Balcony 2	5'10" X 4'11"
Bedroom- 2	12'9" X 10'9"
Wardrobe(Bedroom:2)	4'3" X 1'11"
Toilet 3	4'11" X 9'6"
Balcony 3	7'10" X 4'11"
Kitchen	9'10" X 8'2"
Store/Pooja niche	4'11" X 3'11"
Servant room	7'10" X 8'10"
Toilet 4	3'11" X 4'11"





DRAWING ROOM	<p><b>WALL FINISH</b> : LOW VOC PLASTIC EMULSION ABOVE SKIRTING. FACTORY MADE FLUSH DOOR WITH VENEER FINISH ON BOTH SIDES.</p> <p><b>CEILING FINISH</b> :LOW VOC PLASTIC EMULSION</p> <p><b>FLOOR FINISH</b> :1200 X 600MM GLAZED VITRIFIED TILES</p>
KITCHEN	<p><b>WALL FINISH</b> : GLAZED CERAMIC TILES 600MMX300MM ABOVE COUNTER UP TO 600MM AND IN THE CHIMNEY AREA ABD LOW VOC PLASTIC EMULSION.</p> <p><b>CEILING FINISH</b> :LOW VOC PLASTIC EMULSION</p> <p><b>FLOOR FINISH</b> :1200 X600MM GLAZED VITRIFIED TILES</p>
TOILETS	<p><b>WALL FINISH</b> : GLAZED CERAMIC TILES OF SIZE 600MM X 300MM FROM FLOOR TO FALSE CEILING HEIGHT.</p> <p><b>CEILING FINISH</b> :PERFORATED FALSE CEILING 600 X 600 MM</p> <p><b>FLOOR FINISH</b> :450 X 450MM ANTI SKID VITRIFIED TILES</p>
M BEDROOM	<p><b>WALL FINISH</b> : LOW VOC PLASTIC EMULSION ABOVE SKIRTING.</p> <p><b>CEILING FINISH</b> : LOW VOC PLASTIC EMULSION</p> <p><b>FLOOR FINISH</b> :LAMINATED WOODEN FLOORING</p>
BEDROOM	<p><b>WALL FINISH</b> : LOW VOC PLASTIC EMULSION ABOVE SKIRTING. FACTORY MADE FLUSH DOOR WITH VENEER FINISH ON BOTH SIDES.</p> <p><b>CEILING FINISH</b> : LOW VOC PLASTIC EMULSION</p> <p><b>FLOOR FINISH</b> :1200 X 600MM GLAZED VITRIFIED TILES</p>
STORE/STUDY	<p><b>WALL FINISH</b> : LOW VOC PLASTIC EMULSION ABOVE SKIRTING.</p> <p><b>CEILING FINISH</b> : LOW VOC PLASTIC EMULSION</p> <p><b>FLOOR FINISH</b> :600 X 600MM GLAZED VITRIFIED TILES</p>

BALCONY	<p><b>WALL FINISH</b> : 100 MM HIGH SKIRTING MATCHING THE FLOOR MATERIAL AND TEXTURE PAINT</p> <p><b>CEILING FINISH</b> :EXTERNAL GRADE PAINT</p> <p><b>FLOOR FINISH</b> :450 X 450MM ANTI SKID VITRIFIED TILES</p>
---------	---

COMMON AREA OF TOWER FINISHING

LEISURE PARK

MAIN ENTRANCE LIFT LOBBY GROUND FLOOR	<p><b>WALL FINISH</b> :FULL HEIGHT WALL CLADDING UP TO CEILING WITH PORCELIN STONE TILE IN LIFT LOBBIES AS PER DRAWINGS AND DESIGN.</p> <p><b>CEILING FINISH</b> :FALSE CEILING WITH COVE AND PROFILE LIGHTS</p> <p><b>FLOOR FINISH</b> :COMBINATION OF 18 MM THICK GRANITE STONE</p>
COMMON AREA GROUND FLOOR	<p><b>WALL FINISH</b> :WALL CLADDING WITH GRANITE STONE IN COMBINATION ON LIFT WALL. REST OF THE AREA TO BE FINISHED WITH LOW VOC ACRYLIC EMULSION PAINT</p> <p><b>CEILING FINISH</b> :LOW VOC ACRYLIC EMULSION PAINT WITH ENCLOSED FIRE PIPES</p> <p><b>FLOOR FINISH</b> : COMBINATION OF 18 MM THICK GRANITE STONE</p>
LIFT LOBBY -BASEMENT AND TYPICAL FLOOR	<p><b>WALL FINISH</b> :1200 MM HIGH DADO WITH PORCELIN STONE TILE, LOW PLASTIC EMULSION</p> <p><b>CEILING FINISH</b> :FALSE CEILING WITH COVE PROFILE LIGHTS</p> <p><b>FLOOR FINISH</b> :COMBINATION OF 18 MM THICK GRANITE STONE</p>
LIFT LOBBY -BASEMENT AND TYPICAL FLOOR	<p><b>WALL FINISH</b> :ACRYLIC EMULSION PAINT ABOVE 100 MM HIGH SKIRTING</p> <p><b>CEILING FINISH</b> :LOW VOC ACRYLIC EMULSION PAINT</p> <p><b>FLOOR FINISH</b> :18 MM THICK GRANITE STONE. MS RAILING</p>



# LEISURE PARK

